

ITEM NO.	PART NO.	DESCRIPTION	QTY.	MATERIAL
1	WD11W	1 1/4" NPT SERVICE BOX TOP	1	ASTM A48 CLASS 30
2	SB20B	BASE	1	ABS
3	WD55	PLUG	1	BRASS
4	SB20C	BASE CRADLE	1	ABS
5	WD111	UPPER RISER - 1 1/4" GALV. XL PIPE	1	GALV XL PIPE
6	WD109	LOWER RISER - 1" GALV XL PIPE	1	GALV. XL PIPE
7	WD140	3/8" - 16 UNC H. PT SET SCR. X 3/4" LG	1	GALV.

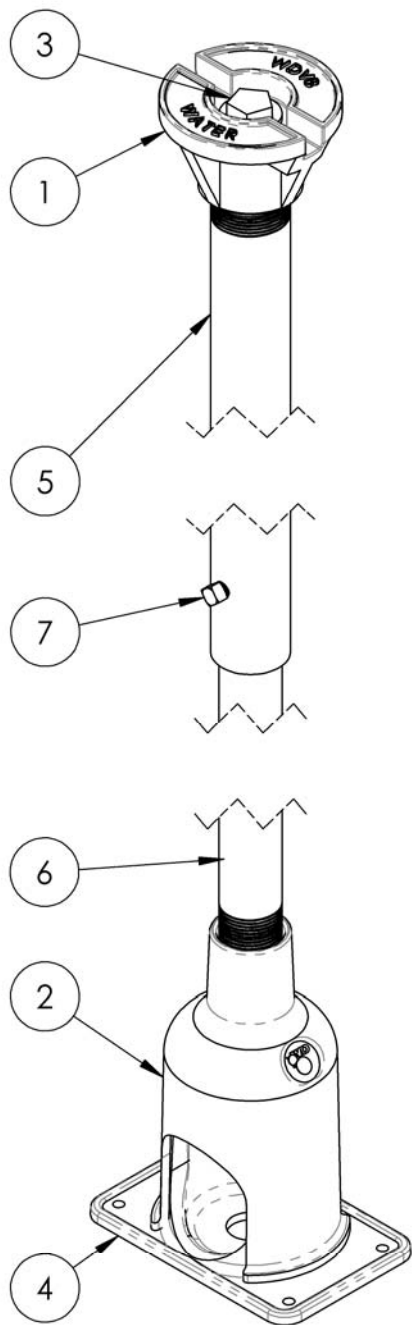

**SERVICE BOX
1/2" TO 1" CURB STOP
1 1/4" MUELLER**

1/2" T304 SS SPINDLE

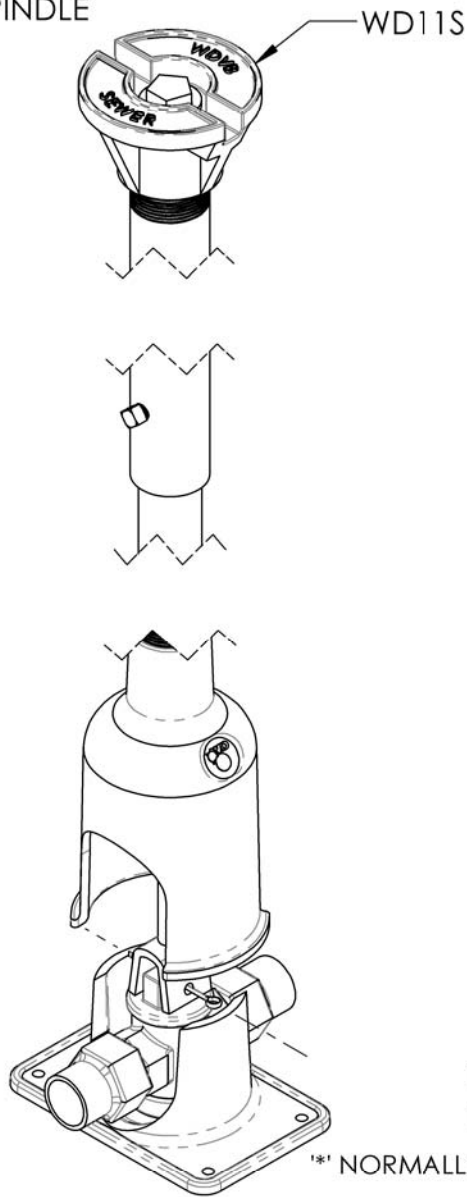

BURIES

- 3' to 5'
- 4' to 6'
- 5' to 7'
- 6' to 8'
- 7' to 9'*
- 8' to 10'*
- 9' to 11'
- 10' to 12'
- 11' to 13'

*1 NORMALLY STOCKED ITEM

**SB20C
SERVICE BOX**

DRAWN		NAME	DATE	
CHECKED		MB	OCT 23/12	
TOLERANCES UNLESS SPECIFIED FRACTIONAL ± 1/32" TWO PLACE DECIMAL ± .02" THREE PLACE DECIMAL ± .002" ANGULAR ± 1°				
DIMENSIONS		INCHES		SIZE
SCALE	1:4	SHEET	1 OF 1	DWG. NO.
				A
				SB 20 XL
				REV.
				0

1036 Waverly Street
Winnipeg, Manitoba, Canada R3T 0P3
P 204 896 1333 F 204 896 6969